

Spare parts list  
**auma**<sup>®</sup>  
 Bevel gearboxes  
 GK 30.2 – GK 40.2

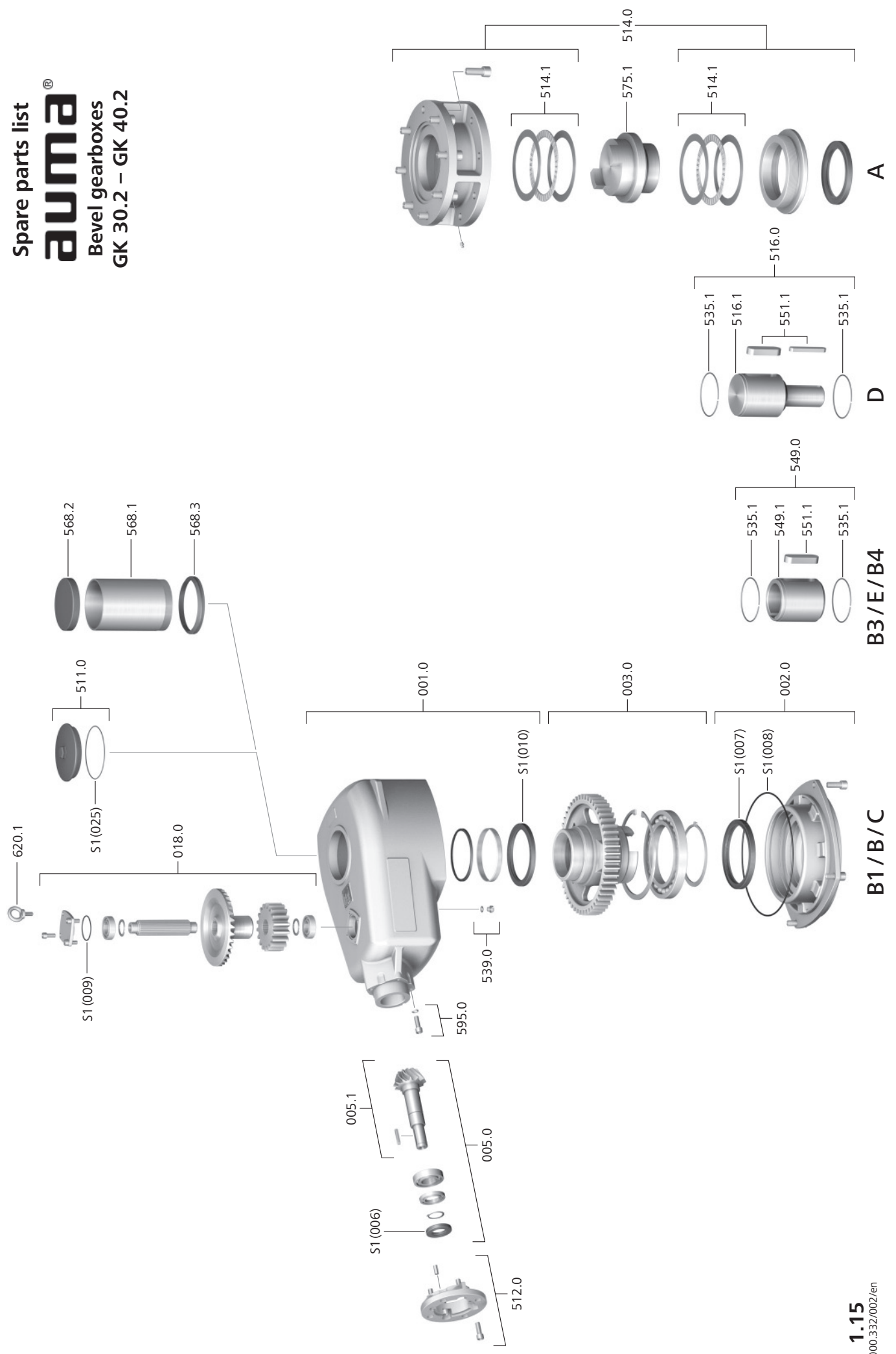

## Spare parts list Bevel gearboxes

Please state type and order no. of the device (see name plate) when ordering spare parts. Only original AUMA spare parts should be used. Failure to use original spare parts voids the warranty and exempts AUMA from any liability. Delivered spare parts may slightly vary from the representation.

Ref. No.	Designation	Type
001.0	Housing	Sub-assembly
002.0	Bearing flange	Sub-assembly
003.0	Hollow shaft	Sub-assembly
005.0	Input shaft	Sub-assembly
005.1	Pinion shaft	
018.0	Intermediate stage	Sub-assembly
511.0	Threaded plug	Sub-assembly
512.0	Input mounting flange	Sub-assembly
514.0	Output drive type A (without stem nut)	Sub-assembly
514.1	Axial needle roller bearing, from GK 35.2: axial cylinder roller bearing	Sub-assembly
516.0	Output drive type D	Sub-assembly
516.1	Output drive shaft D	
535.1	Snap ring	
539.0	Screw plug	Sub-assembly
549.0	Output drive type B3/B4/E	Sub-assembly
549.1	Output drive sleeve B3/B4/E	
551.1	Parallel key	
568.1	Stem protection tube (without cap)	
568.2	Cap for stem protection tube	
568.3	V-seal	
575.1	Stem nut (without thread)	
595.0	Screw kit for manual gearbox	Sub-assembly
620.1	Eyebolt	
S1	Seal kit	Set